

iowa valley elementary scorecard breakdown

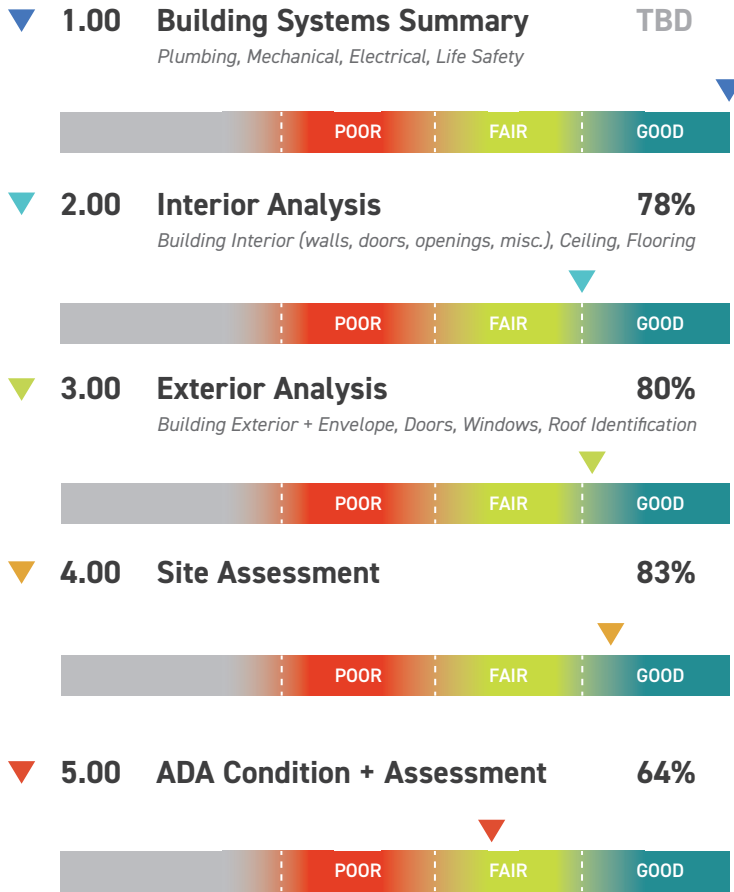

Assessment Weight

- Building Systems Summary
- Interior Analysis
- Exterior Analysis
- Site Assessment
- ADA Condition + Assessment

Overall Building

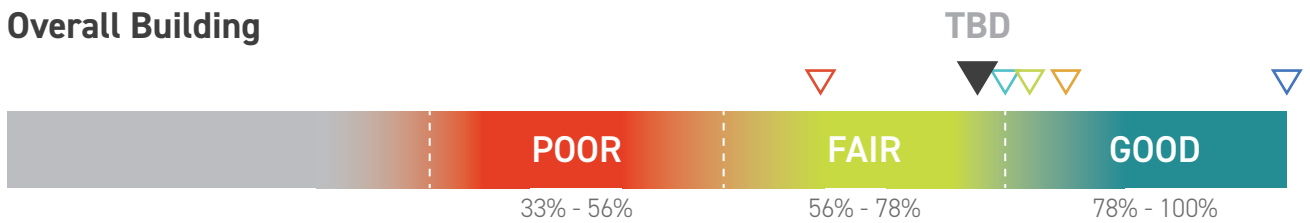

iowa valley elementary interior analysis

OVERALL CONDITION RATING & KEY TAKEAWAYS



- Several instances of wood casework located in the classrooms appear to be in poor condition due to splitting and peeling wood panels.
- The concrete block wall in the fitness room is in poor condition due to staining.
- Majority of concrete block walls throughout the building appear to be in good condition.
- Majority of the terrazzo base in the corridors appear to be in fair condition, with instances of staining, wear, and cracking.
- All of the casework in the kitchen is in poor condition due to several instances of surface scratches, staining, peeling on the wood surface, and missing and/or chipped laminate.

WALLS

- 1 Concrete Block
- 2 Glazed Block
- 3 Tile
- 4 Gypsum
- 5 Plaster
- 6 Brick
- 7 Vinyl Base
- 8 Terrazzo Base
- 9 Tile Base
- 10 Wood Base

DOORS / OPENINGS

- 11 Wood Door w/ Hollow Metal Frame
- 12 Wood Door w/ Hollow Metal Storefront
- 13 Wood Door w/ Wood Frame
- 14 Hollow Metal Door w/ Hollow Metal Frame
- 15 Aluminum Door w/ Aluminum Storefront
- 16 Aluminum Framed Interior Window
- 17 Wood Framed Interior Window
- 18 Aluminum Overhead Coiling Window

MISCELLANEOUS

- 19 Laminate Casework
- 20 Wood Casework w/ Solid Surface
- 21 Metal Toilet Partitions
- 22 Composite Toilet Partitions
- 23 Laminate Window Sill
- 24 Brick Window Sill
- 25 Metal Railings
- 26 Wood Railings
- 27 Metal Lockers
- 28 Coat Shelves / Hooks
- 29 Bleachers
- 30 Wood Locker Benches

iowa valley elementary flooring analysis

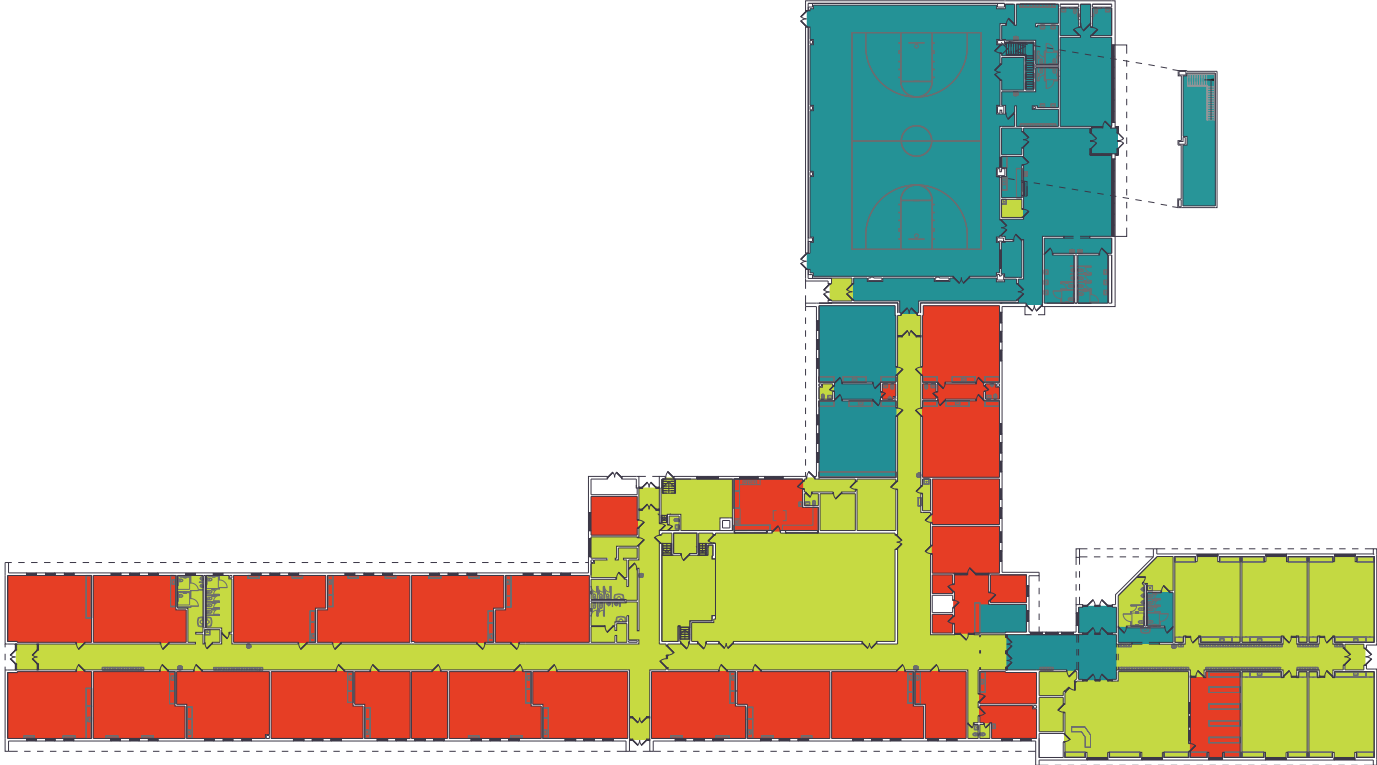

First Floor

KEY TAKEAWAYS

- The flooring in the classrooms in the north wing of the building is in poor condition due to containing potential asbestos tile.
- Majority of the terrazzo flooring in the corridors appears to be in fair condition.
- Majority of the flooring in the 2016 gym addition appears to be in good condition.

HIGHLIGHT

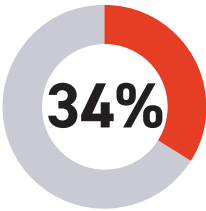

of floors were identified as potential asbestos

OVERALL FLOORING CONDITION



- Good No visible damage
- Fair Some visible damage
- Poor Substantial visible damage